

Snap-On Anchor

Installation & User Guide

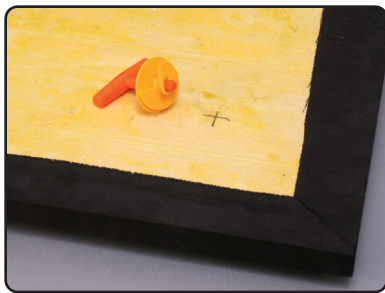

1 Mark each installation point on the back of the panel using a marker 6" in from each side.

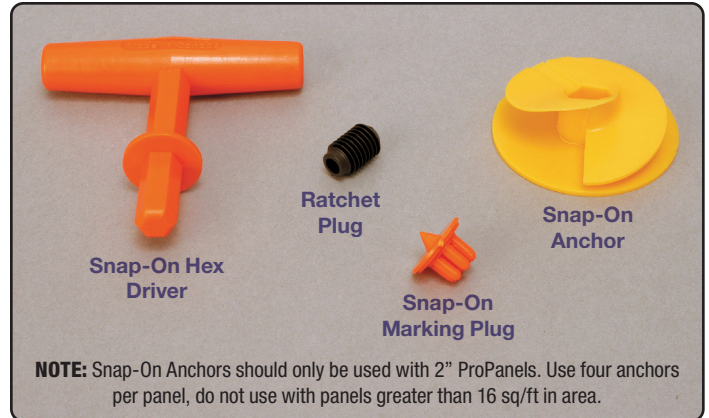

2 Screw the Snap-On Anchors into the back of the panel using the Snap-On Hex Driver tool. Making a small slit with a utility knife can aid in starting the anchors insertion.

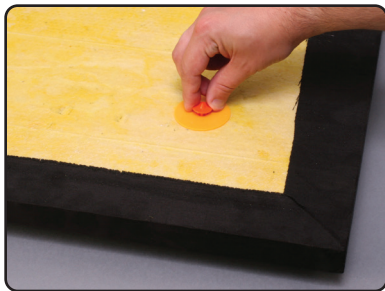

3 Insert marking plugs into the Snap-On anchors.

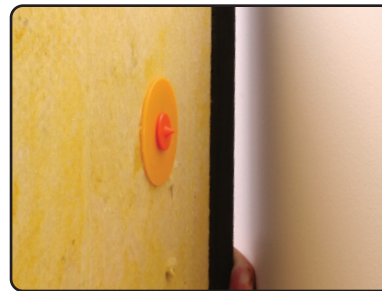

4 Push panel against wall to mark anchor locations.

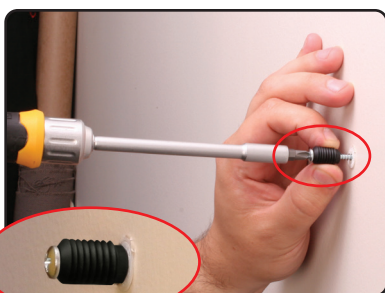

5 Screw ratchet plugs into wall anchors appropriate for your wall construction and weight of your panel. 2' x 2' panels = 8 lb. 2' x 4' panel = 16 lb. 4' x 4' panel = 32 lb.

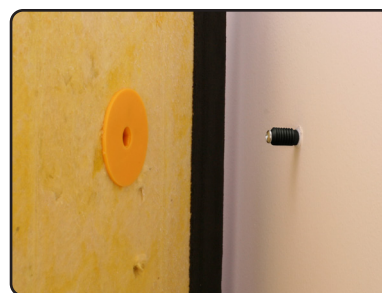

6 Firmly push the panel onto the installed ratchet plugs to complete your installation.

NOTE: Ratchet plugs are directional.

Auralex® Acoustics, Inc.

1-800-959-3343 | 317-842-2600 | Auralex.com
9955 Westpoint Drive, Suite 101, Indianapolis IN USA 46256

Real-World Acoustics®